

ROBERTSON PHILLIPS
Estate Agents, Valuers,
Lettings and Property Management

262a Uxbridge Road, Hatch End,
Pinner, Middlesex HA5 4HS
Tel: 020 8421 4847

E-mail : lettings@robertsonphillips.co.uk

Hatch End : 020 8428 7161

Harrow : 020 8863 1122

Pinner : 020 8866 7151



**ROBERTSON
PHILLIPS**

Est. 1991



Beeton Close, Pinner

£1,795 P.C.M

Key Features include:

- Two Double Bedrooms
- End Of Terrace
- New Kitchen & Bathroom
- Laminate Flooring Throughout
- Gas Central Heating
- Double Glazing
- Rear garden
- Parking On Street
- Unfurnished

Property Overview:

Perfectly positioned within a short walk to Hatch End Broadway, this **TWO DOUBLE** bedroom end of terrace house has undergone recent improvements and offers ultra contemporary interiors ideal for a small family. Sought after restaurants, bars, overground station and Grimsdyke Primary School are nearby. **UNFURNISHED**

Accommodation:

Entrance

Laminate flooring, door to:

Lounge/Dining Room 18' 7" x 12' 2" (5.66m x 3.71m)

Window to front, laminate flooring and stairs.

Kitchen/Breakfast Room 12' 2" x 8' 1" (3.71m x 2.46m)

Newly fitted with a matching range of base and eye level units with worktop space over, stainless steel sink with single drainer and mixer tap, fridge/freezer, washing machine, electric fan assisted oven, four ring gas hob with extractor hood over, window to rear and laminate flooring. Door to rear garden.

Landing

Laminate flooring.

Principal Bedroom 12' 6" x 10' 4" (3.81m x 3.15m)

Window to front, storage cupboard, laminate floor and wardrobe with sliding door.

Bedroom 2 12' 4" x 8' 0" (3.76m x 2.44m)

Window to rear, laminate flooring and door to storage cupboard.

Bathroom

Newly fitted with three piece suite comprising of deep panelled bath with independent shower over, glass screen, vanity wash hand basin with cupboards under, low-level flush WC, tiled surround, wall mounted mirrored cabinet, window to side, heated towel rail and ceramic tiled flooring.

Outside

Rear garden with patio area and shed. Ample parking on street.

Council Tax Band: D EPC Rating: TBC





To arrange a viewing call:
020 8421 4847

Robertson Phillips
262a Uxbridge Road, Hatch End, Pinner, HA5 4HS

Ground Floor

Approx. 31.9 sq. metres (343.0 sq. feet)

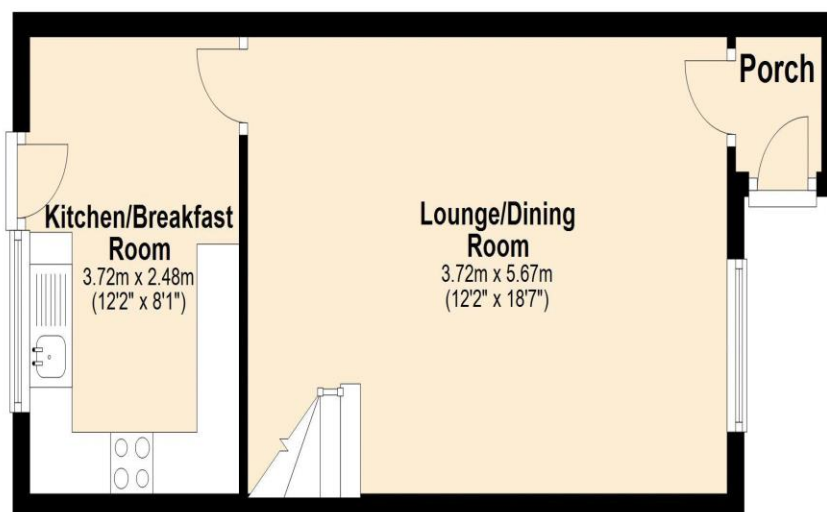

First Floor

Approx. 32.0 sq. metres (344.0 sq. feet)

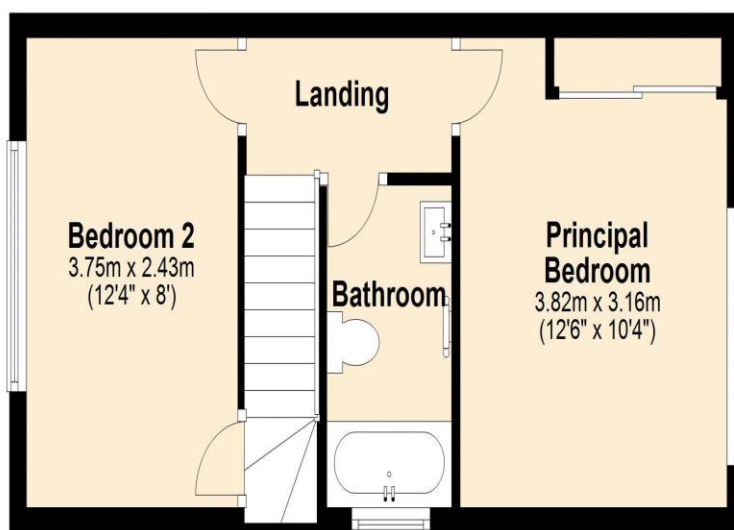

Total area: approx. 63.8 sq. metres (687.0 sq. feet)



DISCLAIMER: Robertson Phillips may not have sought to verify the legal title of the property, the existence of planning permissions and/or building regulation approvals and have been unable to check the working condition of any services or appliances.

Property layouts are for general guidance and are not drawn exactly to scale. Measurements are taken at the widest points and bays, alcoves, wardrobes etc. may not be shown.